



# MSC IN FINANCE

*A professional degree guided industry*



CENTRAL  
EUROPEAN  
UNIVERSITY



# CENTRAL EUROPEAN UNIVERSITY

**39<sup>th</sup>**  
**IN THE**  
**WORLD**

*Times Higher Education  
Young University  
Rankings 2017*

**42<sup>nd</sup>**  
**IN THE**  
**WORLD**

*QS World University  
Rankings 2017  
in Politics and  
International Studies*

**TOP**  
**100**

*QS World University  
Rankings 2017  
in Philosophy, Sociology,  
and Social Policy and  
Administration*

**19**

**RESEARCH  
CENTERS**

**8:1**

**STUDENT/  
FACULTY RATIO**

**116**

**COUNTRIES**

A U.S. graduate school in Budapest, the heart of Europe

- founded in 1991, specialized in social sciences
- Master's and PhD degrees taught exclusively in English
- Times World Universities 2017
  - #301-350 – Brunel, Georgia, Temple, York
  - #39 under-50, #85 in U.S., #1 in Hungary, #2 in CEE
  - #2 most international
- QS World Universities 2017: Economics and Econometrics
  - #150-200 – Dauphine, Georgia Tech, Zhejiang, TU Berlin
  - #47 in U.S., #1 in Hungary, #3 in CEE
- European Research Council 2014
  - #8 in economics and finance research grants

# | CEU COMMUNITY

Join one of the most diverse and far-reaching university networks in the world

- 1,500 students from 116 countries
- 300 faculty from more than 40 countries
- global alumni network in 150 countries, alumni groups in 72 countries



# BUDAPEST, HUNGARY

## Work in one of Europe's fastest rising financial services and technology hubs

- European center for global employers actively competing for international talent
  - Bank of China, BlackRock, Citi, Erste, KBC, Morgan Stanley, MSCI
  - BT, Cognizant, EPAM, HP, IBM, Nokia, SAP, T-Systems, TCS, Unisys, Vodafone
  - Avis, BP, Diageo, ExxonMobil, GE, Genpact, Roche, UNHCR, UNICEF

## Live in one of the world's best, most beautiful and most expat-friendly cities

- European Union and Schengen Area
- World #2 city in Condé Nast Traveler, #21 for expats in InterNations
- modest housing and living expenses by international comparison



# DEPARTMENT OF ECONOMICS AND BUSINESS

## A. PROFESSIONAL DEGREE PROGRAMS

- Full-time or part-time
- 1-year full-time for graduates and career changers
- 16/22 months part-time for working professionals

MSc	Business Analytics
MSc	Finance
MSc	Technology Management
CEU InnovationsLab	
MA	Global Economic Relations

## B. ACADEMIC DEGREE PROGRAMS

- full-time
- 2-year master's degrees
- 4-year PhD degrees

MA	Economic Policy in Global Markets
MA	Economics
PhD	Economics
PhD	Management

# TEACHING FACULTY

Learn from leading research faculty and industry practitioners

Worked at

Berkeley, Boston, Chicago, Federal Reserve NY, Harvard, Michigan, MIT, NBER, Northeastern, NYU, Princeton, UT Austin, LBS, LSE, Cambridge, Oxford, ECB, ESSEC, Mannheim, WU

PhDs from

Boston, Harvard, Michigan, MIT, Northwestern, Penn State, Princeton, UC San Diego, Yale, LSE, Cambridge, Bristol, Sussex, INSEAD, Tilburg, EUI, Max Planck, ECARES, Pisa

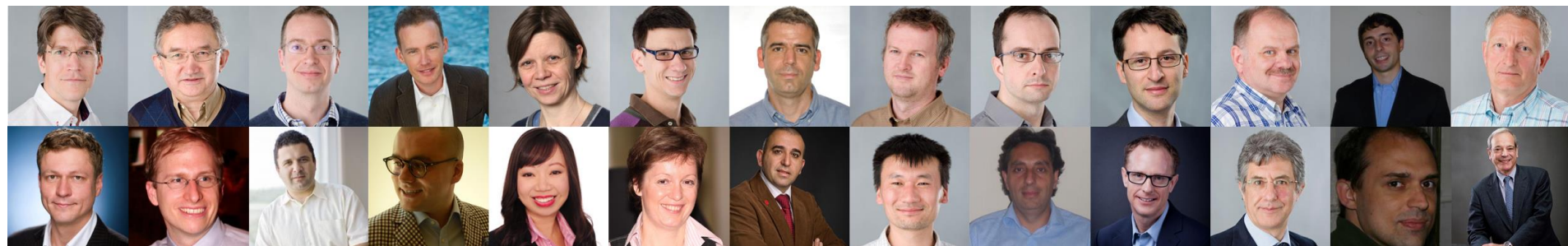

# PROFESSIONAL DEGREE PROGRAMS

Business education at the cutting edge, guided by industry

- full-time (12 months) or part-time (16/22 months)
- constantly evolving curricula with great flexibility and opportunities
  - Fintech Management Dual Degree
  - develop your own startup in the CEU InnovationsLab
- international exchanges free of tuition in the Americas, Asia and Europe

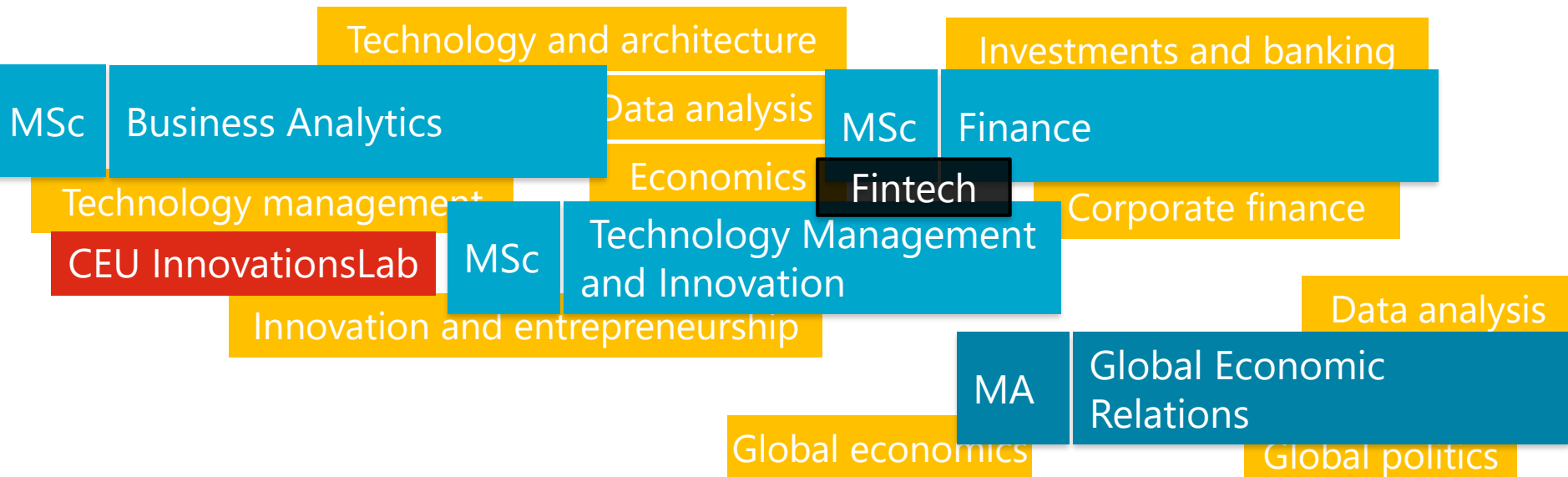

# MSC IN FINANCE

- U.S. Master of Science degree
- 30 credits (60 ECTS credits)
- 12 months full-time, 16/22 months part-time
- Tuition: €10,000
- The cutting edge of finance for all career needs
  - corporate finance
  - investments and banking
  - data analysis and technology
- Strong industry focus
  - MSc in Finance Advisory Committee
  - Finance@CEU expert series
  - capstone project, cases, simulations
- Fintech Management Dual Degree



Students	35
Nationalities	20
Age	30, 22–44
Experience	8, 1–19



# ADVISORY COMMITTEE

## Working group of senior executives guiding the MSc in Finance

- set professional standards and advise on the curriculum
- contribute courses, case studies, simulations, site visits
- help with internships and careers

János Babos Managing Partner Process Solutions	Björn Bergabo General Manager GE	Attila Bozsó Regional Director EPAM	Tommy Erdei Managing Director Jefferies (UK)	Norbert Fogarasi Managing Director Morgan Stanley
Elemér Gidófalvy Managing Director Unicredit	Orsolya Hegedűs Partner M&A Advisory Deloitte (AT)	Ákos Janza Head of Office MSCI	Levente Jánoskúti Managing Partner McKinsey	László Juhász Managing Partner BCG
George Juscsák Executive Director JP Morgan (AT)	Zsolt Katona Chairman Hiventures	Nick Kós Managing Partner PwC	Zoltán Major Managing Director OTP (RU)	Melanie Seymour Head of Office Blackrock
István Szabó Deputy CEO CIB Intesa	György Ungár Managing Director Citi	László Urbán Board Member NLB (SI)	Bence Várady-Szabó Managing Director Affidea	Balázs Vinnai General Manager Misys

# CURRICULUM

## CORE COURSES (*mandatory*)

Accounting  
Finance  
Business Economics  
Investments I & II

## OUTER CORE COURSES (*take 2*)

Behavioral Finance  
Regulatory and Policy Environment  
Finance & Strategy

## ELECTIVES

Corporate Financial Risk Management  
Company Valuation and Restructuring  
Corporate Governance  
Boardroom Global Challenge  
Entrepreneurial Finance  
Project Appraisal  
Strategic Managerial Accounting  
Current Issues in Financial Reporting

Banking and Financial Institutions  
Fixed Income Analysis  
Personal Finance  
Private Equity and Venture Capital  
Banking IT and Fintech  
Financial Trading Design, Technology

## DATA ANALYSIS

Data Analysis  
Data First  
Data Science 1-2: Machine Learning  
Advanced Data Science  
Data Visualization  
Stochastic Analysis  
Theory of Algorithm  
Matlab, Python, R, SPSS, SQL, VBA

## LEGAL

Capital Markets, Securities Regulation  
Comparative Bankruptcy Law  
International Investment Law  
Legal Aspects of Corporate Finance

# FINANCE@CEU AND CAPSTONE FIELD PROJECT



## Finance@CEU Expert Speaker Series

- meet senior executives working at the cutting edge of finance
- topical themes and real finance issues
- informal meeting sessions



## Capstone Field Project

- individual consulting assignment
- work with a host company on a real business issue
- commercially relevant training to operationalize your knowledge



"The CEU experience was crucial in my career development. I was looking for a game changer, a program that had the characteristics that the job market is looking for without neglecting academics."

*Kevin Pirazzi, NKGB Strategic Advisory*

# FINTECH MANAGEMENT DUAL DEGREE

- Two Master of Science degrees
  - MSc in Finance
  - MSc in Technology Management and Innovation
- 46-60 credits (92-120 ECTS credits)
  - transfer up to 14 credits-in-common
  - corresponding tuition reduction
- 12/16/22 months, full-time or part-time
  - or earn one degree now, then return for second degree within six years
- Central Europe's first fintech degree program
- Pioneering interdisciplinary learning also covering fintech management
  - finance and data analytics
  - technology and architecture
  - innovation, management, entrepreneurship
- Develop your own fintech startup in the InnovationsLab

MSc Finance

MSc Technology Management and Innovation

CEU InnovationsLab



# ADDITIONAL CURRICULUM

## CORE COURSES (*mandatory*)

Agile Project Management  
Best Practices in IT Service Management  
Digital Marketing  
Digital Transformation  
e-Leadership  
Organizational Behavior and HR  
Technology-based Entrepreneurship  
Technology Innovation  
(Cognitive and Smart Systems)

## ELECTIVES

Banking IT and Fintech  
Boardroom Global Challenge  
Business Intelligence  
Consultative Selling and Negotiation  
Developing a New Venture  
Digital Strategy  
Effective Selling Skills and Strategies  
Ethics of Big Data  
Information Lifecycle Management  
IoT – Industry 4.0  
Security and Data Protection  
User Experience Design



“The courses strongly encourage collaborative work among classmates from various firms and government organizations. This leads to broader knowledge sharing as well as excellent networking opportunities.”

*Andrea Barabás, Citi*

# CEU INNOVATIONSLAB

## Startup incubator for CEU students and alumni

- Students and alumni: Have a startup idea?
  - Study with CEU and develop your own venture
- Startups: Need research or planning support?
  - Our faculty experts and students can help
- Mentors and advisors: Want to give back?
  - Your experience could lead a CEU startup to success
- Investors: Interested in funding opportunities?
  - We can introduce you to promising startups

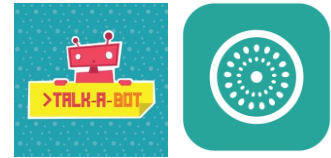

**AbsoRice**

**BROKERCHOOSE**

**CASHless**  
mobile payments

**Say Hello**  
The Global Translation Marketplace

reclamatio

**Valuella**



# INTERNATIONAL EXCHANGES

Extend your studies abroad to internationalize your network, broaden your horizons

- study abroad free of tuition for an additional semester, or as little as one week
- specialize further in your field, or broaden your skills in other areas of business
- broaden your international network, or move your career to another country

Partner schools in the Americas, Asia and Europe

- Brandeis (US), York (CA), IPADE (MX), EBAPE (BR)
- SJTU (CN), Hitotsubashi (JP), Ewha (KR), ESSEC (SG), IIM Ahmedabad (IN)
- ESSEC, NEOMA (FR), EBS, KLU, TU Freiberg (DE)



# CEU CAREERS

100% of Class of 2016 graduates employed within three months of graduation

- Corporate showcases by global employers seeking international talent
  - Amazon, BlackRock, Citi, GE, Google, Microsoft, Morgan Stanley, MSCI, TCS
- CareerNext integrated job platform and Career Days & Fair
  - bringing together students and alumni with partner employers
- Career and internship support by MSc in Finance Advisory Committee





# ENTRY REQUIREMENTS

## Requirements

- Bachelor's (or higher) degree with good GPA
- Competitive TOEFL *or* equivalent English proficiency score
- Two letters of recommendation
- CEU mathematics test *or* competitive GMAT/GRE *or* CFA (1 & 2) *or* ACCA (1-8)

## Exemptions

- TOEFL: native speaker *or* prior degree in English
- Math test: 5 years of relevant work experience, 30 years of age



# TUITION AND SCHOLARSHIPS

## MSC IN FINANCE TUITION FEE FOR SEPTEMBER 2017: €10,000

Tuition fee in keeping with CEU's mandate to develop open societies worldwide

- Deeply below cost, considerably lower than at comparable schools
- To allow access to emerging market candidates worldwide



### Future of Big Data Scholarship & Training Program

- MSc in Business Analytics, MSc in Finance
- full tuition, mentor by London investment firm
- possible internship in London
- quantitative and programming background required



### Empiricus Scholarship Program

- MSc in Finance
- partial tuition by Hong Kong investment firm
- possible internship in Beijing or Hong Kong
- for Chinese candidates with quantitative background

# OUR HOME

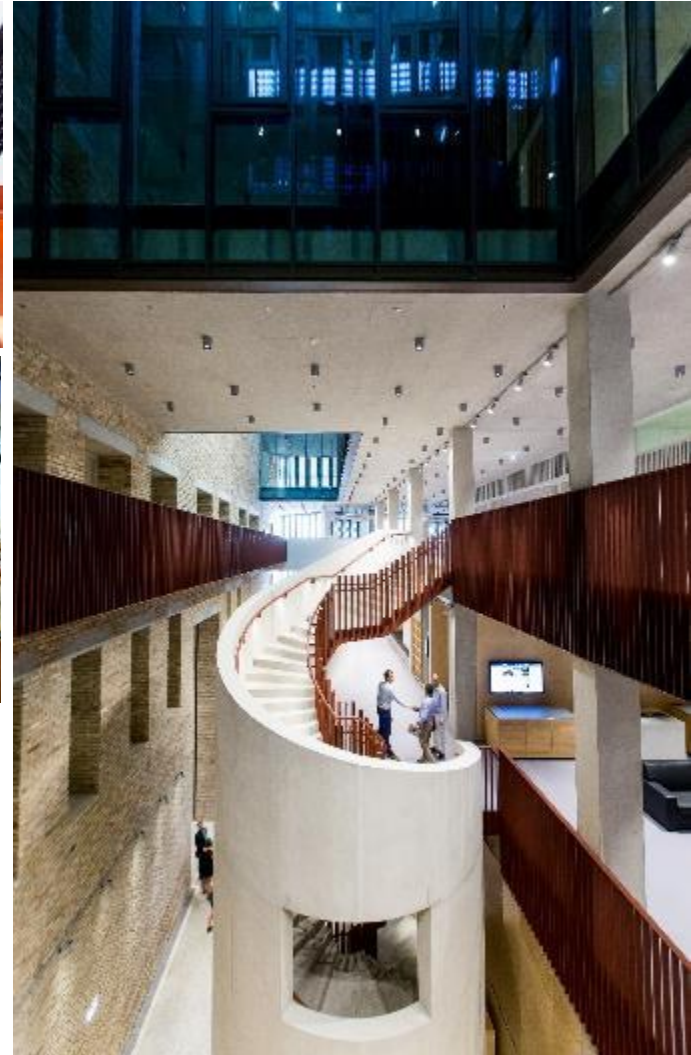

# CONTACT

[business.ceu.edu/msc-in-finance](http://business.ceu.edu/msc-in-finance)  
[economics.ceu.edu/msc-finance](http://economics.ceu.edu/msc-finance)



## Peter G. Szilagyi

Associate Professor of Finance  
MSc in Finance Faculty Director

[szilagyip@business.ceu.edu](mailto:szilagyip@business.ceu.edu)

[people.ceu.edu/peter\\_szilagyi](http://people.ceu.edu/peter_szilagyi)  
[linkedin.com/in/pgszilagyi](https://www.linkedin.com/in/pgszilagyi)

*"The MSc in Finance is guided by a strong industry coalition and is constantly evolving. I have built on a decade of experience at Cambridge and Oxford to design a program that global employers actually need both as a source of talent and a means of talent support."*



## Agnes Schram

Admissions Manager

[schrama@business.ceu.edu](mailto:schrama@business.ceu.edu)



## Hari Subedi

Recruitment Coordinator

[subedim@business.ceu.edu](mailto:subedim@business.ceu.edu)